

District I  
PO Box 1980, Hobbs, NM 88241-1980  
District II  
PO Drawer DD, Artesia, NM 88211-0719  
District III  
1000 Rio Brazos Rd., Aztec, NM 87410  
District IV  
PO Box 2088, Santa Fe, NM 87504-2088

State of New Mexico  
Energy, Minerals & Natural Resources Department

OIL CONSERVATION DIVISION  
PO Box 2088  
Santa Fe, NM 87504-2088

Form C-101  
Revised February 10, 1994  
Instructions on back  
Submit to Appropriate District Office  
State Lease - 6 Copies  
Fee Lease - 5 Copies

☐ AMENDED REPORT

APPLICATION FOR PERMIT TO DRILL, RE-ENTER, DEEPEN, PLUGBACK, OR ADD A ZONE

Operator Name and Address. Santa Fe Energy Resources, Inc. 550 W. Texas, Suite 1330 Midland, TX 79701		OGRID Number 20305
Property Code 9088	Property Name Spessartine "27" State POTASH AREA	API Number 30-025-33491
		Well No. 1

7 Surface Location

UL or lot no.	Section	Township	Range	Lot Ida	Feet from the	North/South line	Feet from the	East/West line	County
L	27	21-S	33-E		1980	North South	1980 990	West	Lea

8 Proposed Bottom Hole Location If Different From Surface

UL or lot no.	Section	Township	Range	Lot Ida	Feet from the	North/South line	Feet from the	East/West line	County
Proposed Pool 1 Lea Atoka Morrow					Proposed Pool 2				

Work Type Code N	Well Type Code G	Cable/Rotary R	Lease Type Code S	Ground Level Elevation 3685
Multiple No	Proposed Depth 15000	Formation Morrow	Contractor to be determined	Spud Date 6-1-95

21 Proposed Casing and Cement Program

Hole Size	Casing Size	Casing weight/foot	Setting Depth	Sacks of Cement	Estimated TOC
17 1/2"	13 3/8"	48.0	650'	650 sx	surface
12 1/4"	9 5/8"	40.0	5200'	2600 sx	surface
8 3/4"	7"	26.0	12000'	700 sx	7000'
6 1/8"	4 1/2"	13.5	15000'	500 sx	surface

Describe the proposed program. If this application is to DEEPEN or PLUG BACK give the data on the present productive zone and proposed new productive zone. Describe the blowout prevention program, if any. Use additional sheets if necessary.

Rig up rotary tools. Set 13 3/8" casing at 650', WOC 12 hours, NU annular preventor and test casing to 600 psi. Set 9 5/8" casing at 5200', WOC 12 hours and NU 10M triple ram BOP w/annular. Test casing to 2000 psi. Set 7" casing at 12000', install a rotating head and test BOP stack and choke manifold to 10000 psi. Test casing to 3000 psi. Drill to a TD of  $\pm 15000'$ .

I hereby certify that the information given above is true and complete to the best of my knowledge and belief.

Signature:

Printed name:

Title:

Date:

James P. "Phil" Stinson

James P. "Phil" Stinson

Agent for Santa Fe Energy

5-23-95

Phone:

(915) 682-6373

OIL CONSERVATION DIVISION

Approved by:

Title:

Approval Date:

JUN 24 1996

Expiration Date:

Conditions of Approval:

Attached ☐

C-101 Instructions

Measurements and dimensions are to be in feet/inches. Well locations will refer to the New Mexico Principal Meridian.

IF THIS IS AN AMENDED REPORT CHECK THE BOX LABLED "AMENDED REPORT" AT THE TOP OF THIS DOCUMENT.

- |  |  |
|--|--|
| <p>1 Operator's OGRID number. If you do not have one it will be assigned and filled in by the District office.</p> <p>2 Operator's name and address</p> <p>3 API number of this well. If this is a new drill the OCD will assign the number and fill this in.</p> <p>4 Property code. If this is a new property the OCD will assign the number and fill it in.</p> <p>5 Property name that used to be called 'well name'</p> <p>6 The number of this well on the property.</p> <p>7 The surveyed location of this well New Mexico Principal Meridian NOTE: If the United States government survey designates a Lot Number for this location use that number in the 'UL or lot no.' box. Otherwise use the OCD Unit Letter.</p> <p>8 The proposed bottom hole location of this well at TD</p> <p>9 and 10 The proposed pool(s) to which this well is being drilled.</p> <p>11 Work type code from the following table:<br/> N New well<br/> E Re-entry<br/> D Drill deeper<br/> P Plugback<br/> A Add a zone</p> <p>12 Well type code from the following table:<br/> O Single oil completion<br/> G Single gas completion<br/> M Multiple completion<br/> I Injection well<br/> S SWD well<br/> W Water supply well<br/> C Carbon dioxide well</p> <p>13 Cable or rotary drilling code<br/> C Propose to cable tool drill<br/> R Propose to rotary drill</p> <p>14 Lease type code from the following table:<br/> F Federal<br/> S State<br/> P Private<br/> N Navajo<br/> J Jicarilla<br/> U Ute<br/> I Other Indian tribe</p> <p>15 Ground level elevation above sea level</p> <p>16 Intend to multiple complete? Yes or No</p> <p>17 Proposed total depth of this well</p> | <p>18 Geologic formation at TD</p> <p>19 Name of the intended drilling company if known.</p> <p>20 Anticipated spud date.</p> <p>21 Proposed hole size ID inches, proposed casing OD inches, casing weight in pounds per foot, setting depth of the casing or depth and top of liner, proposed cementing volume, and estimated top of cement</p> <p>22 Brief description of the proposed drilling program and BOP program. Attach additional sheets if necessary.</p> <p>23 The signature, printed name, and title of the person authorized to make this report. The date this report was signed and the telephone number to call for questions about this report.</p> |
|--|--|

**RECEIVED**

MAY 26 1985

OCD HOBBS  
OFFICE

DISTRICT I  
P. O. Box 1980  
Hobbs, NM 88241-1980

State of New Mexico  
Geology, Minerals, and Natural Resources Department

Form C-102  
Revised 02-10-94

Instructions on back

DISTRICT II  
P. O. Drawer DD  
Artesia, NM 88211-0719

**OIL CONSERVATION DIVISION**  
P. O. Box 2088  
Santa Fe, New Mexico 87504-2088

Submit to the Appropriate  
District Office  
State Lease - 4 copies  
Fee Lease - 3 copies

DISTRICT III  
1000 Rio Brazos Rd.  
Aztec, NM 87410

☐ AMENDED REPORT

DISTRICT IV  
P. O. Box 2088  
Santa Fe, NM 87507-2088

**WELL LOCATION AND ACREAGE DEDICATION PLAT**

1 API Number		2 Pool Code		3 Pool Name Grama Ridge (Morrow)					
4 Property Code		5 Property Name SPESSARTINE '27' STATE						6 Well Number 1	
7 OGRID No.		8 Operator Name SANTA FE ENERGY RESOURCES, INC.						9 Elevation 3685'	
10 SURFACE LOCATION									
UL or lot no. L	Section 27	Township 21 SOUTH	Range 33 EAST, N.M.P.M.	Lot Ida	Feet from the 1980'	North/South line SOUTH	Feet from the 990'	East/West line WEST	County LEA
"BOTTOM HOLE LOCATION IF DIFFERENT FROM SURFACE									
UL or lot no.	Section	Township	Range	Lot Ida	Feet from the	North/South line	Feet from the	East/West line	County
12 Dedicated Acres 320		13 Joint or Infill		14 Consolidation Code		15 Order No.			

NO ALLOWABLE WELL BE ASSIGNED TO THIS COMPLETION UNTIL ALL INTERESTS HAVE BEEN  
CONSOLIDATED OR A NON-STANDARD UNIT HAS BEEN APPROVED BY THE DIVISION

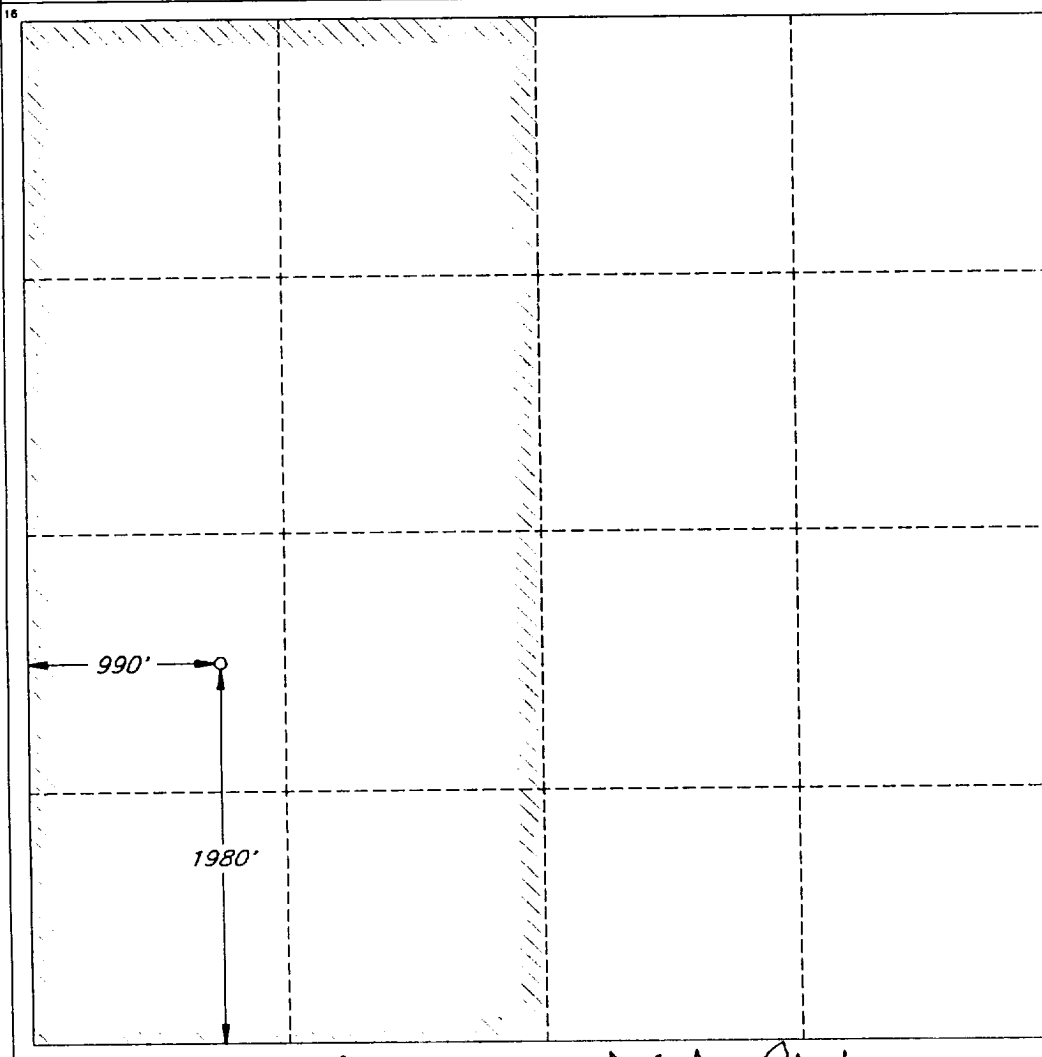

**OPERATOR CERTIFICATION**

I hereby certify that the information  
contained herein is true and complete  
to the best of my knowledge and belief.

Signature: *James P. Phil Stinson*  
Printed Name: James P. "Phil" Stinson  
Title: Agent for Santa Fe Energy  
Date: May 23, 1995

**SURVEYOR CERTIFICATION**

I hereby certify that the well  
location shown on this plat was  
plotted from field notes of actual  
surveys made by me or under  
my supervision, and that the  
same is true and correct to the  
best of my belief.

Date of Survey  
MAY 16, 1995

Signature and Seal of  
Professional Surveyor  
  
Certificate No.  
V. L. BEZNER, S.S. #7920  
JOB #99487 AND 97 NE / V.H.R.

see amended Plat

New Mexico Oil Conservation Division  
C-102 Instructions

IF THIS IS AN AMENDED REPORT, CHECK THE BOX LABELED  
"AMENDED REPORT" AT THE TOP OF THIS DOCUMENT.

Surveyors shall use the latest United States government survey or dependent resurvey. Well locations will be in reference to the New Mexico Principal Meridian. If the land is not surveyed contact the appropriate OCD district office. Independent subdivision surveys will not be acceptable.

1. The OCD assigned API number for this well
2. The pool code for this (proposed) completion
3. The pool name for this (proposed) completion
4. The property code for this (proposed) completion
5. The property name (well name) for this (proposed) completion
6. The well number for this (proposed) completion
7. Operator's OGRID number
8. The operator's name
9. The ground level elevation of this well
10. The surveyed surface location of this well measured from the section lines. NOTE: If the United States government survey designates a Lot Number for this location use that number in the "UL or lot no." box. Otherwise use the OCD unit letter.
11. Proposed bottom hole location. If this is a horizontal hole indicate the location of the end of the hole.
12. The calculated acreage dedicated to this completion to nearest hundredth of an acre
13. Put a Y if more than one completion will be sharing this same acreage or N if this is the only completion on this acreage
14. If more than one lease of different ownership has been dedicated to the well show the consolidation code from the following table:

C	Communitization
U	Unitization
F	Forced pooling
O	Other
P	Consolidation pending

NO ALLOWABLE WILL BE ASSIGNED TO THIS COMPLETION UNTIL ALL INTERESTS HAVE BEEN CONSOLIDATED OR A NON-STANDARD UNIT HAS BEEN APPROVED BY THE DIVISION!

16. This grid represents a standard section. You may superimpose a non-standard section over this grid. Outline the dedicated acreage and the separate leases within that dedicated acreage. Show the well surface location and bottom hole location, if it is directionally drilled, with the dimensions from the section lines in the dimensions from the section lines in the cardinal directions. (Note: A legal location is determined from the perpendicular distance to the edge of the tract.) If this is a high angle or horizontal hole show that portion of the well bore that is open within this pool.

Show all lots, lot numbers, and their respective acreage.

If more than one lease has been dedicated to this completion, outline each one and identify the ownership as to both working interest and royalty.

17. The signature, printed name, and title of the person authorized to make this report, and the date this document was signed.
18. The Registered surveyors certification. This section does not have to be completed if this form has been previously accepted by the OCD and is being filed for a change of pool or dedicated acreage.

RECEIVED

15. Write in the OCD order(s) approving a non-standard location, non-standard spacing, or directional or horizontal drilling

Submit 3 Copies  
to Appropriate  
District Office

State of New Mexico  
Energy, Minerals and Natural Resources Department

Form C-103  
Revised 1-1-89

DISTRICT I  
P.O. Box 1980, Hobbs, NM 88240

DISTRICT II  
P.O. Drawer DD, Artesia, NM 88210

DISTRICT III  
1000 Rio Brazos Rd., Aztec, NM 87410

OIL CONSERVATION DIVISION  
P.O. Box 2088  
Santa Fe, New Mexico 87504-2088

WELL API NO.

5. Indicate Type of Lease

STATE ☒

FEE ☐

6. State Oil & Gas Lease No.  
E-1932

7. Lease Name or Unit Agreement Name

Spessartine "27" State

8. Well No.

1

9. Pool name or Wildcat

Grama Ridge (Morrow)

SUNDRY NOTICES AND REPORTS ON WELLS  
(DO NOT USE THIS FORM FOR PROPOSALS TO DRILL OR TO DEEPEN OR PLUG BACK TO A  
DIFFERENT RESERVOIR. USE "APPLICATION FOR PERMIT"  
(FORM C-101) FOR SUCH PROPOSALS.)

1. Type of Well:

OIL  
WELL ☐

GAS  
WELL ☒

OTHER

2. Name of Operator

Santa Fe Energy Resources, Inc.

3. Address of Operator

550 W. Texas, Suite 1330; Midland, TX 79701

4. Well Location

Unit Letter F : 1980 Feet From The North Line and 1980 Feet From The West Line

Section 27 Township 21-S Range 33-E NMPM Lea County

10. Elevation (Show whether DF, RKB, RT, GR, etc.)

3714 GR

11. Check Appropriate Box to Indicate Nature of Notice, Report, or Other Data

NOTICE OF INTENTION TO:

PERFORM REMEDIAL WORK ☐

PLUG AND ABANDON ☐

TEMPORARILY ABANDON ☐

CHANGE PLANS ☐

PULL OR ALTER CASING ☐

OTHER: Amend Surface Location ☒

SUBSEQUENT REPORT OF:

REMEDIAL WORK ☐ ALTERING CASING ☐

COMMENCE DRILLING OPNS. ☐ PLUG AND ABANDONMENT ☐

CASING TEST AND CEMENT JOB ☐

OTHER: ☐

12. Describe Proposed or Completed Operations (Clearly state all pertinent details, and give pertinent dates, including estimated date of starting any proposed work) SEE RULE 1103.

Santa Fe Energy Resources respectfully requests the surface location of the  
Spessartine "27" State #1 be moved from (L) 1980' FSL & 990' FWL Sec. 27,  
T-21-S, R-33-E to (F) 1980' FNL & 1980' FWL, Sec. 27, T-21-S, R-33-E.

I hereby certify that the information above is true and complete to the best of my knowledge and belief.

SIGNATURE

James P. "Phil" Stinson

TITLE Agent for Santa Fe Energy DATE 6-14-95

TYPE OR PRINT NAME

James P. "Phil" Stinson

TELEPHONE NO. (915) 682-6373

(This space for State Use)

APPROVED BY

TITLE

DATE

CONDITIONS OF APPROVAL, IF ANY:

DISTRICT I  
P. O. Box 1980  
Hobbs, NM 88241-1980

State of New Mexico  
Energy, Minerals, and Natural Resources Department

Form C-102  
Revised 02-10-94

Instructions on back

DISTRICT II  
P. O. Drawer DD  
Artesia, NM 88211-0719

## OIL CONSERVATION DIVISION

P. O. Box 2088  
Santa Fe, New Mexico 87504-2088

Submit to the Appropriate  
District Office  
State Lease - 4 copies  
Fee Lease - 3 copies

☒ AMENDED REPORT

DISTRICT III  
1000 Rio Brazos Rd.  
Aztec, NM 87410

DISTRICT IV  
P. O. Box 2088  
Santa Fe, NM 87507-2088

### WELL LOCATION AND ACREAGE DEDICATION PLAT

1 API Number 30-025-33491		2 Pool Code 8D120		3 Pool Name LOPP HOKA <del>Crema Ridge</del> (Morrow)					
4 Property Code 19088		5 Property Name SPESSARTINE '27' STATE						6 Well Number 1	
7 OGRID No. 20305		8 Operator Name SANTA FE ENERGY RESOURCES, INC.						9 Elevation 3714'	
10 SURFACE LOCATION									
UL or lot no. F	Section 27	Township 21 SOUTH	Range 33 EAST, N.M.P.M.	Lot Ida	Feet from the 1980'	North/South line NORTH	Feet from the 1980'	East/West line WEST	County LEA
11 BOTTOM HOLE LOCATION IF DIFFERENT FROM SURFACE									
UL or lot no.	Section	Township	Range	Lot Ida	Feet from the	North/South line	Feet from the	East/West line	County
12 Dedicated Acres 320		13 Joint or Infill		14 Consolidation Code		15 Order No.			

NO ALLOWABLE WELL BE ASSIGNED TO THIS COMPLETION UNTIL ALL INTERESTS HAVE BEEN  
CONSOLIDATED OR A NON-STANDARD UNIT HAS BEEN APPROVED BY THE DIVISION

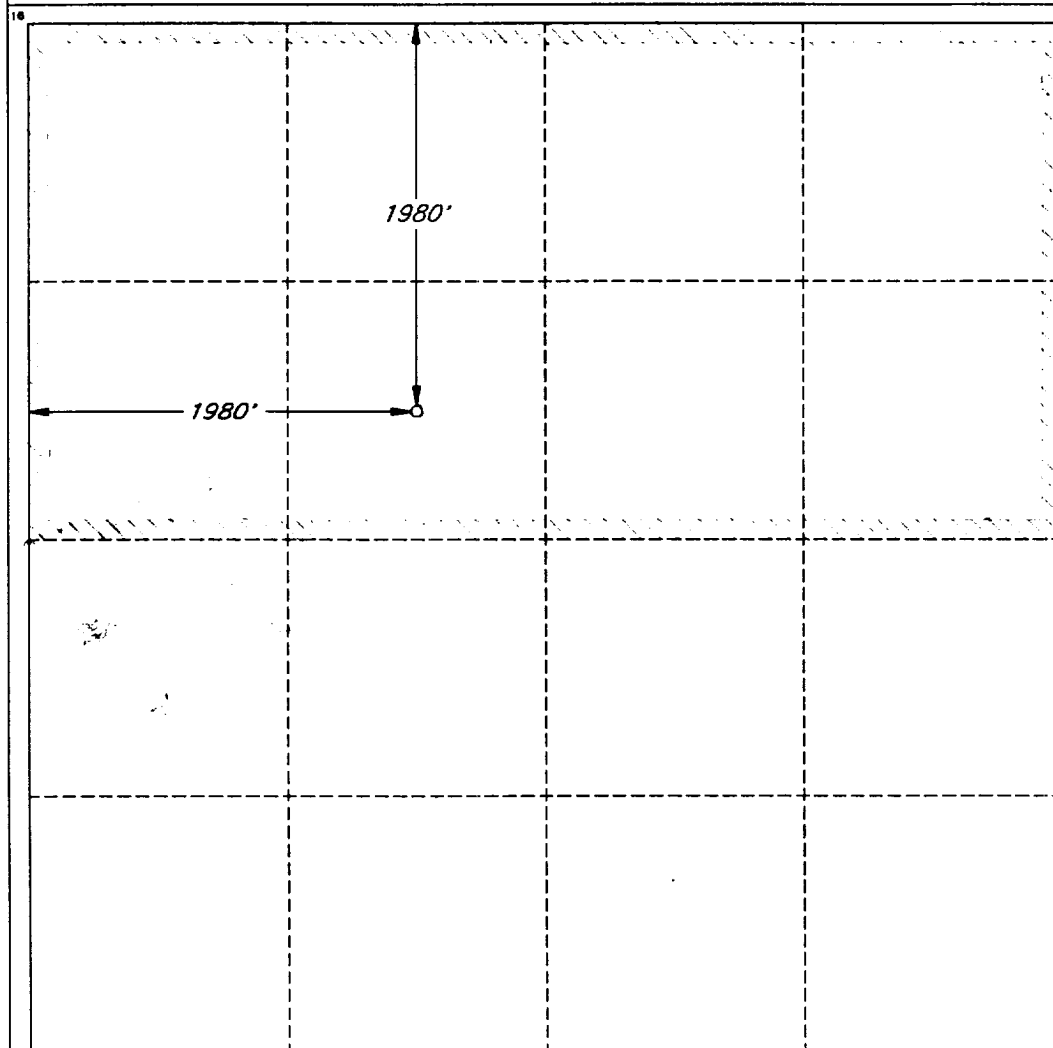

#### OPERATOR CERTIFICATION

I hereby certify that the information  
contained herein is true and complete  
to the best of my knowledge and belief.

Signature  
*James P. "Phil" Stinson*  
Printed Name  
James P. "Phil" Stinson  
Title  
Agent for Santa Fe Energy  
Date  
6-13-95

#### SURVEYOR CERTIFICATION

I hereby certify that the well  
location shown on this plat was  
plotted from field notes of actual  
surveys made by me or under  
my supervision, and that the  
same is true and correct to the  
best of my belief.

Date of Survey  
JUNE 8, 1995

Signature and Seal of  
Professional Surveyor  
*V. Lynn Beiner*  
Certification  
V. LYNN BEINER  
NO. 7920  
V. L. BEINER LAND P.S. #7920

JOB #39937 / 47 NE / V.H.B.

Submit 3 Copies  
to Appropriate  
District Office

State of New Mexico  
Energy, Minerals and Natural Resources Department

Form C-103  
Revised 1-1-89

DISTRICT I  
P.O. Box 1980, Hobbs, NM 88240

DISTRICT II  
P.O. Drawer DD, Artesia, NM 88210

DISTRICT III  
1000 Rio Brazos Rd., Aztec, NM 87410

OIL CONSERVATION DIVISION  
P.O. Box 2088  
Santa Fe, New Mexico 87504-2088

WELL API NO.

5. Indicate Type of Lease

STATE ☒

FEE ☐

6. State Oil & Gas Lease No.

E-1932

SUNDRY NOTICES AND REPORTS ON WELLS  
(DO NOT USE THIS FORM FOR PROPOSALS TO DRILL OR TO DEEPEN OR PLUG BACK TO A  
DIFFERENT RESERVOIR. USE "APPLICATION FOR PERMIT"  
(FORM C-101) FOR SUCH PROPOSALS.)

1. Type of Well:

OIL  
WELL ☐

GAS

WELL ☒

OTHER

2. Name of Operator

Santa Fe Energy Resources, Inc.

3. Address of Operator

550 W. Texas, Suite 1330; Midland, TX 79701

4. Well Location

Unit Letter F : 1980 Feet From The North Line and 1980 Feet From The West Line

Section 27

Township 21-S

Range 33-E

NMPM

Lea

County

10. Elevation (Show whether DF, RKB, RT, GR, etc.)

3714 GR

11.

Check Appropriate Box to Indicate Nature of Notice, Report, or Other Data

NOTICE OF INTENTION TO:

PERFORM REMEDIAL WORK ☐

PLUG AND ABANDON ☐

TEMPORARILY ABANDON ☐

CHANGE PLANS ☐

PULL OR ALTER CASING ☐

OTHER: Potash Information

☒

SUBSEQUENT REPORT OF:

REMEDIAL WORK ☐

ALTERING CASING ☐

COMMENCE DRILLING OPNS. ☐

PLUG AND ABANDONMENT ☐

CASING TEST AND CEMENT JOB ☐

OTHER: ☐

12. Describe Proposed or Completed Operations (Clearly state all pertinent details, and give pertinent dates, including estimated date of starting any proposed work) SEE RULE 1103.

As per your request please find attached:

1. Plat showing Potash Lessees

2. Waiver from Potash Lessee

I hereby certify that the information above is true and complete to the best of my knowledge and belief.

SIGNATURE

James P. "Phil" Stinson

TITLE

Agent for Santa Fe Energy

DATE

6-14-95

TYPE OR PRINT NAME

James P. "Phil" Stinson

TELEPHONE NO. (915) 682-6373

(This space for State Use)

APPROVED BY

TITLE

DATE

CONDITIONS OF APPROVAL, IF ANY:



**FAX/  
CERTIFIED/RETURN RECEIPT**

June 6, 1995

Eddy Potash Company, Inc.  
P.O. Box 31  
Carlsbad, NM 88220

Attention: Mr. Robert Kirby

Re: T-21-S, R-33-E  
Section 27: N/2  
Lea County, New Mexico



Gentlemen:

Santa Fe Energy Resources, Inc. (Santa Fe) plans to file an APD for a well located in the above captioned lands. The well is to be located 1980' FNL and 1980' FWL of the referenced section.

Santa Fe requests that Eddy Potash Company, Inc. waive objections to this proposed location. If you are in agreement with this request, please sign one copy of this letter in the space provided below and return it to me at the address below.

If you have any questions or need additional information, please call me at 915/686-6712.

Yours very truly,

**SANTA FE ENERGY RESOURCES, INC.**

By: Danita R. Walker  
Danita R. Walker, CPL  
Landman

DRW:ms

Central Division  
550 W. Texas, Suite 1330  
Midland, Texas 79701  
915/687-3551



June 6, 1995  
Eddy Potash Company, Inc.  
Page 2

AGREED TO AND ACCEPTED this 8 day of June, 1995.

EDDY POTASH COMPANY, INC.

By: Robert F. Kroy  
Printed Name: Robert F. Kroy  
Title: Plant Manager

**RECEIVED**  
JUN 15 1966  
U C D HOBBS  
OFFICE

[illegible]

RECEIVED  
JUN 1 1985  
OCLC  
CENTRE