

VICINITY MAP

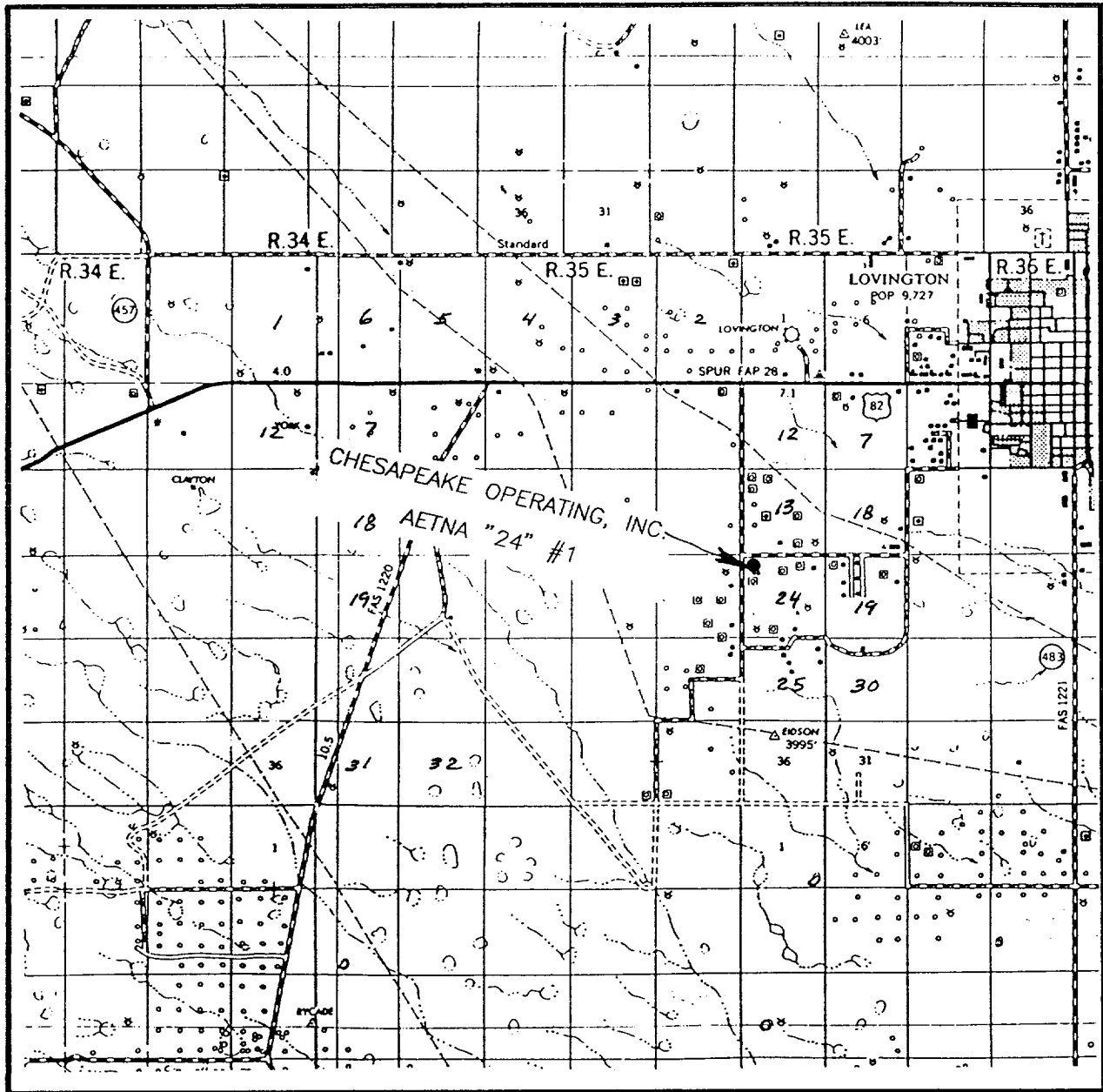

SCALE: 1" = 2 MILES

SEC. 24 TWP. 16-S RGE. 35-E

SURVEY N.M.P.M.

COUNTY LEA

DESCRIPTION 660' FNL & 660' FWL

ELEVATION 3965'

OPERATOR CHESAPEAKE OPERATING, INC.

LEASE AETNA "24"

**JOHN WEST ENGINEERING
HOBBS, NEW MEXICO**

(505) 393-3117