

UNITED STATES  
DEPARTMENT OF THE INTERIOR  
GEOLOGICAL SURVEY

## APPLICATION FOR PERMIT TO DRILL, DEEPEN, OR PLUG BACK

## 1a. TYPE OF WORK

DRILL ☒DEEPEN ☐PLUG BACK ☐

## b. TYPE OF WELL

OIL  
WELL ☒GAS  
WELL ☐OTHER ☐SINGLE  
ZONE ☒MULTIPLE  
ZONE ☐

## 2. NAME OF OPERATOR

Amoco Production Company

## 3. ADDRESS OF OPERATOR

P. O. Box 68 Hobbs, NM 88240

## 4. LOCATION OF WELL (Report location clearly and in accordance with any State requirements.)

At surface

At proposed prod. zone

1670' FNL &amp; 1650' FWL, Sec. 30, T. 36N, R. 10E, S. 30E, SE/4, NW/4, Unit F, SE/4, NW/4, HOBBS, NEW MEXICO

## 14. DISTANCE IN MILES AND DIRECTION FROM NEAREST TOWN OR POST OFFICE\*

9.7 miles Southwest of Milnesand, NM

## 15. DISTANCE FROM PROPOSED\*

LOCATION TO NEAREST  
PROPERTY OR LEASE LINE, FT.  
(Also to nearest drlg. unit line, if any)18. DISTANCE FROM PROPOSED LOCATION\*  
TO NEAREST WELL, DRILLING, COMPLETED,  
OR APPLIED FOR, ON THIS LEASE, FT.

## 16. NO. OF ACRES IN LEASE

## 19. PROPOSED DEPTH

4850'

17. NO. OF ACRES ASSIGNED  
TO THIS WELL

40

## 20. ROTARY OR CABLE TOOLS

Rotary

## 21. ELEVATIONS (Show whether DF, RT, GR, etc.)

4216.9' GL

## 22. APPROX. DATE WORK WILL START\*

## 23.

## PROPOSED CASING AND CEMENTING PROGRAM

SIZE OF HOLE	SIZE OF CASING	WEIGHT PER FOOT	SETTING DEPTH	QUANTITY OF CEMENT
12-1/4"	8-5/8"	36#	450'	Circ. to surf.
7-7/8"	5-1/2"	17#	4660'	Circ. to surf.

Propose to drill and equip well in the San Andres formation. After reaching TD, logs will be run and evaluated; perforate and stimulate as necessary in attempting commercial production.

MUD PROGRAM: 0'-450' Native mud and fresh water  
450'-TD Commercial mud and brine water with minimum properties for safe hole conditions.

BOP Program Attached  
Archaeological Survey Attached

IN ABOVE SPACE DESCRIBE PROPOSED PROGRAM: If proposal is to deepen or plug back, give data on present productive zone and proposed new productive zone. If proposal is to drill or deepen directionally, give pertinent data on subsurface locations and measured and true vertical depths. Give blowout preventer program, if any.

## 24.

SIGNED

*Gerald L. Foshee*

TITLE

Admin. Analyst

DATE

1-30-81.

(This space for Federal or State office use)

PERMIT NO.

APPROVAL DATE

APPROVED BY

TITLE

DATE

CONDITIONS OF APPROVAL, IF ANY:

0+6-USGS, H

1-Hou

1-Susp

1-GLF

1-W. Stafford, Hou

\*See Instructions On Reverse Side

**MEXICO OIL CONSERVATION COMMISSION  
WELL LOCATION AND ACREAGE DEDICATION PLAT**

Form C-102  
Supersedes C-128  
Effective 1-1-65

All distances must be from the outer boundaries of the Section

Operator <b>Amoco Production Co.</b>			Lease <b>Horton Fed.</b>		Well No. <b>33</b>
Unit Letter <b>F</b>	Section <b>31</b>	Township <b>8 South</b>	Range <b>35 East</b>	County <b>Roosevelt</b>	
Actual Footage Location of Well: <div style="display: flex; justify-content: space-between;"> <span><b>1670</b> feet from the <b>north</b> line and</span> <span><b>1650</b> feet from the <b>west</b> line</span> </div>					
Ground Level Elev. <b>4216.9</b>	Producing Formation <b>San Andres</b>	Pool <b>Milnesand-San Andres</b>	Dedicated Acreage: <b>40</b> Acres		

1. Outline the acreage dedicated to the subject well by colored pencil or hatchure marks on the plat below.
2. If more than one lease is dedicated to the well, outline each and identify the ownership thereof (both as to working interest and royalty).
3. If more than one lease of different ownership is dedicated to the well, have the interests of all owners been consolidated by communitization, unitization, force-pooling, etc?

☐ Yes   ☐ No   If answer is "yes," type of consolidation \_\_\_\_\_

If answer is "no," list the owners and tract descriptions which have actually been consolidated. (Use reverse side of this form if necessary.) \_\_\_\_\_

No allowable will be assigned to the well until all interests have been consolidated (by communitization, unitization, forced-pooling, or otherwise) or until a non-standard unit, eliminating such interests, has been approved by the Commission.

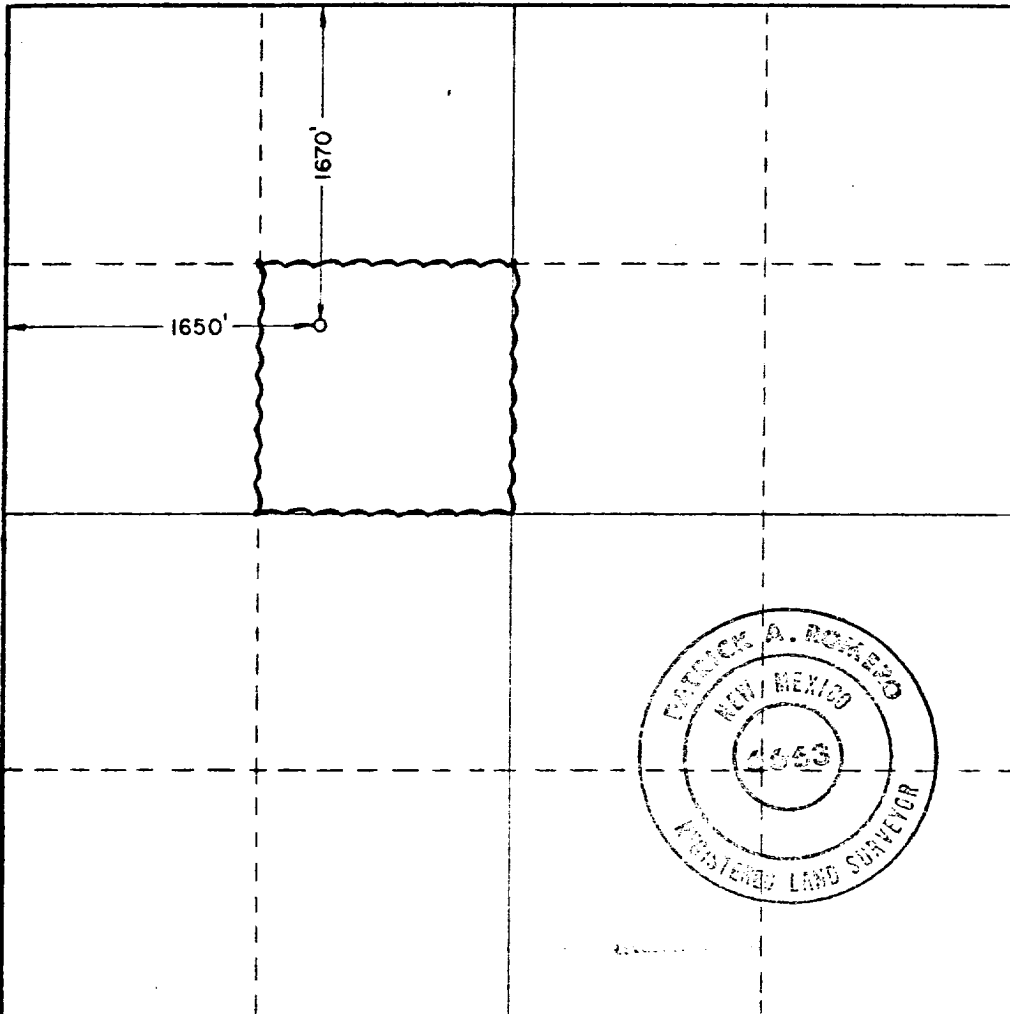

**CERTIFICATION**

I hereby certify that the information contained herein is true and complete to the best of my knowledge and belief.

Name **Gerald L. Foshel**

Position  
**Admin. Analyst**

Company  
**Amoco Production Company**

Date  
**1-30-81**

I hereby certify that the well location shown on this plat was plotted from field notes of actual surveys made by me or under my supervision, and that the same is true and correct to the best of my knowledge and belief.

Date Surveyed  
**Jan. 9, 1981**

Registered Professional Engineer and/or Land Surveyor

**Patrick A. Romero**

Certificate No. **JOHN W. WEST 676**  
**PATRICK A. ROMERO 8488**  
**Ronald J. Eidson 3239**

0 330 660 990 1320 1650 1980 2310 2640 2970 3300 3630 3960 4290 4620 4950 5280 5610 5940 6270 6600