

UNITED STATES
DEPARTMENT OF THE INTERIOR

GEOLOGICAL SURVEY

APPLICATION FOR PERMIT TO DRILL, DEEPEN, OR PLUG BACK

1a. TYPE OF WORK

DRILL ☒DEEPEN ☐PLUG BACK ☐

b. TYPE OF WELL

OIL
WELL ☒GAS
WELL ☐OTHER ☐SINGLE
ZONE ☐MULTIPLE
ZONE ☐

2. NAME OF OPERATOR

Enserch Exploration, Inc.

3. ADDRESS OF OPERATOR

1230 River Bend Drive - Suite 136 - Dallas, TX 75247-4995

4. LOCATION OF WELL (Report location clearly and in accordance with all State regulations)

At surface

660' FSL & 510' FEL (SE $\frac{1}{4}$ - SE $\frac{1}{4}$)

At proposed prod. zone

Same

14. DISTANCE IN MILES AND DIRECTION FROM NEAREST TOWN OR POST OFFICE*

8 miles East of Elida, New Mexico

10. DISTANCE FROM PROPOSED*

LOCATION TO NEAREST

PROPERTY OR LEASE LINE, FT.

(Also to nearest drig. unit line, if any)

510'

18. DISTANCE FROM PROPOSED LOCATION*

TO NEAREST WELL, DRILLING, COMPLETED,
OR APPLIED FOR, ON THIS LEASE, FT.

3960'

16. NO. OF ACRES IN LEASE

520'

19. PROPOSED DEPTH

8300'

17. NO. OF ACRES ASSIGNED
TO THIS WELL

80

20. ROTARY OR CABLE TOOLS

Rotary

21. ELEVATIONS (Show whether DF, RT, GR, etc.)

4360.3' GR

22. APPROX. DATE WORK WILL START*

January 1, 1982

23.

PROPOSED CASING AND CEMENTING PROGRAM

SIZE OF HOLE	SIZE OF CASING	WEIGHT PER FOOT	SETTING DEPTH	QUANTITY OF CEMENT
17-1/2"	13-3/8"	48#	350'	460 sx - Circulate to surface
12-1/4"	9-5/8"	36#	2000'	995 sx - Circulate to surface
8-3/4"	5-1/2"	15.5# & 17.0#	8300'	700 sx - Cement to 6250'

Propose to drill a 17-1/2" hole to 350', set 13-3/8" surface casing and cement to surface. A 13-3/8", 3000 psi bradenhead and a 12", 3000 psi annulus preventer will be installed and tested before drilling the intermediate hole. Drill a 12-1/4" hole to 2000', set 9-5/8" intermediate casing and cement to surface. The 13-3/8" bradenhead will be removed and a 9-5/8", 3000 psi bradenhead and 12", 3000 psi double hydraulic BOP's installed. Drill an 8-3/4" hole to 8300', log, evaluate, and set 5-1/2" production casing at T.D. This is a Mississippian Lime test.

EXHIBITS ATTACHED

A. Location and Elevation Plat

E. Access Road Map

B. Ten-Point Compliance Program

F. Radius Map of Existing Wells

C. Blow-Out Preventer Diagram

G. Drill rig Layout and Cross Sections

D. Multi-Point Requirements for A.P.D.

H. Archeological Clearance Report

IN ABOVE SPACE DESCRIBE PROPOSED PROGRAM: If proposal is to deepen or plug back, give data on present productive zone and proposed new productive zone. If proposal is to drill or deepen directionally, give pertinent data on subsurface locations and measured and true vertical depths. Give blowout preventer program, if any.

24.

SIGNED

C. H. Peeples

TITLE Regional Drilling Manager

DATE 11-18-81

(This space for Federal or State office use)

PERMIT NO.

APPROVED

APPROVED BY

CONDITIONS OF APPROVAL, IF ANY

JAN 15 1982

JAMES A. GILLHAM

DISTRICT SUPERVISOR *See Instructions On Reverse Side

APPROVAL SUBJECT TO
GENERAL REQUIREMENTS AND
SPECIAL STIPULATIONS
ATTACHED

DATE

30-041-20638

5. LEASE DESIGNATION AND SERIAL NO.

NM 37611

6. IF INDIAN, ALLOTTEE OR TRIBAL RECEIVED

N/A

7. UNIT AGREEMENT NAME

N/A

JAN 19 1982

8. FARM OR LEASE NAME

Scott-Federal

O. C. D.

9. WELL NO.

ARTESIA OFFICE

3

10. FIELD AND POOL, OR WILDCAT

Peterson Mississippian

11. SEC., T., R., M., OR BLK.
AND SURVEY OR AREA

Sec. 20, T4S-R33E

12. COUNTY OR PARISH

Roosevelt

13. STATE
New Mexico

**MEXICO OIL CONSERVATION COMMISSION
WELL LOCATION AND ACREAGE DEDICATION PLAT**

Form C-102
Supersedes C-128
Effective 1-1-65

All distances must be from the outer boundaries of the Section

Enserch Exploration, Inc.			Lease Scott Federal		Acres 3
Section P	Section 20	Township 4 South	Range 33 East	County Roosevelt	
Actual Estimated Location of Well: 660 feet from the South line and 510 feet from the East					
Ground Level Elev. 4360.3'	Producing Formation Mississippian Lime		Pool Peterson Mississippian		Estimated Acreage 80

1. Outline the acreage dedicated to the subject well by colored pencil or hatchure marks on the plat below.
2. If more than one lease is dedicated to the well, outline each and identify the ownership thereof (both as to working interest and royalty).
3. If more than one lease of different ownership is dedicated to the well, have the interests of all owners been consolidated by communitization, unitization, force-pooling, etc?

☐ Yes ☐ No If answer is "yes," type of consolidation _____

If answer is "no," list the owners and tract descriptions which have actually been consolidated (Use reverse side of this form if necessary.) _____

No allowable will be assigned to the well until all interests have been consolidated (by communitization, unitization, forced-pooling, or otherwise) or until a non-standard unit, eliminating such interests, has been approved by the Commission.

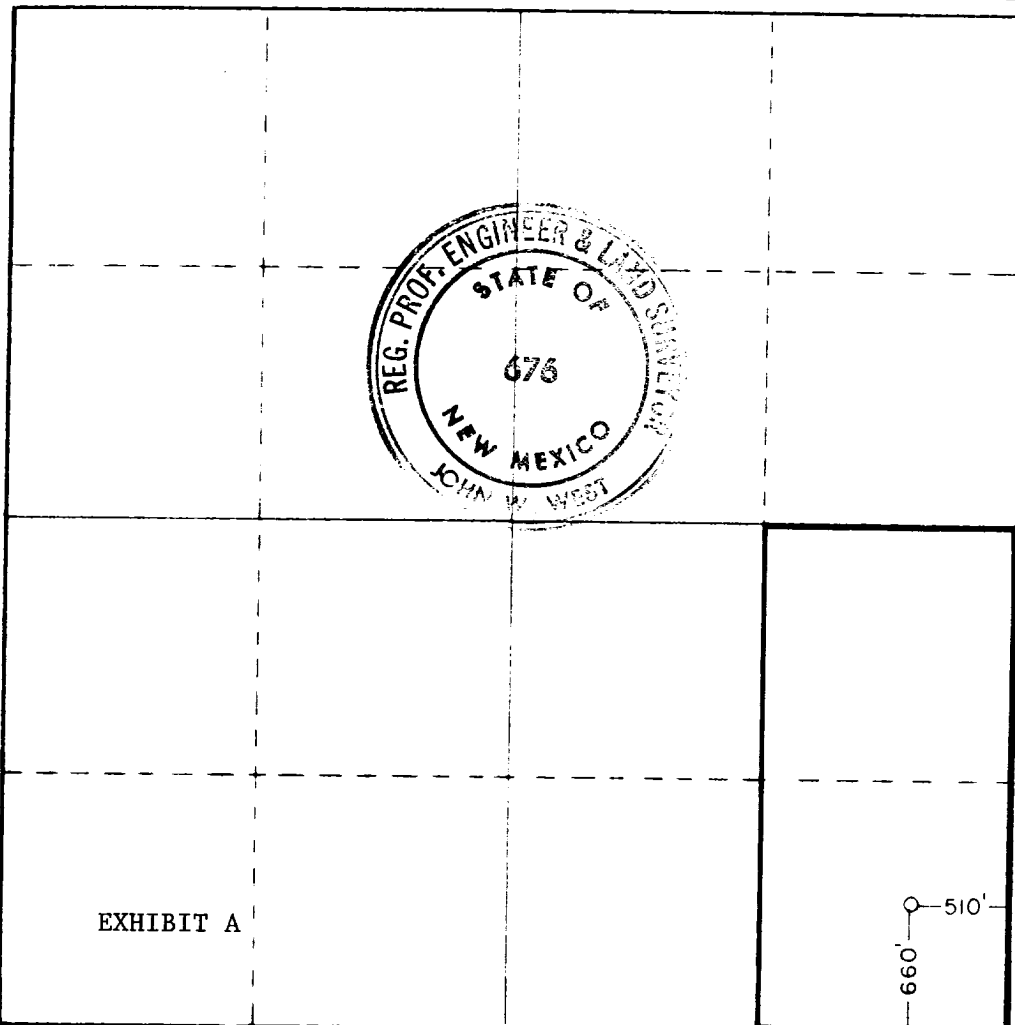

CERTIFICATION

I hereby certify that the information contained herein is true and complete to the best of my knowledge and belief.

C. H. Peeples

Name
C. H. Peeples

Position
Regional Drilling Manager

Employer
Enserch Exploration, Inc.

Date
November 25, 1981

I hereby certify that the well location shown on this plat was plotted from field notes of actual surveys made by me or under my supervision, and that the same is true and correct to the best of my knowledge and belief.

Date Surveyed

Sept. 30, 1981

Registered Professional Engineer and/or Land Surveyor

John W. West

Certificate No. JOHN W. WEST 676
PATRICK A. ROMERO 6868
Ronald J. Eide 2220

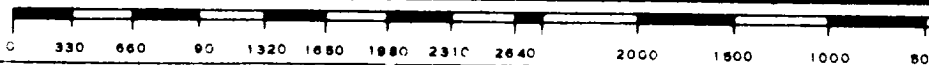

ENSERCH EXPLORATION, INC.

MINIMUM REQUIREMENTS FOR BLOW OUT PREVENTION EQUIPMENT

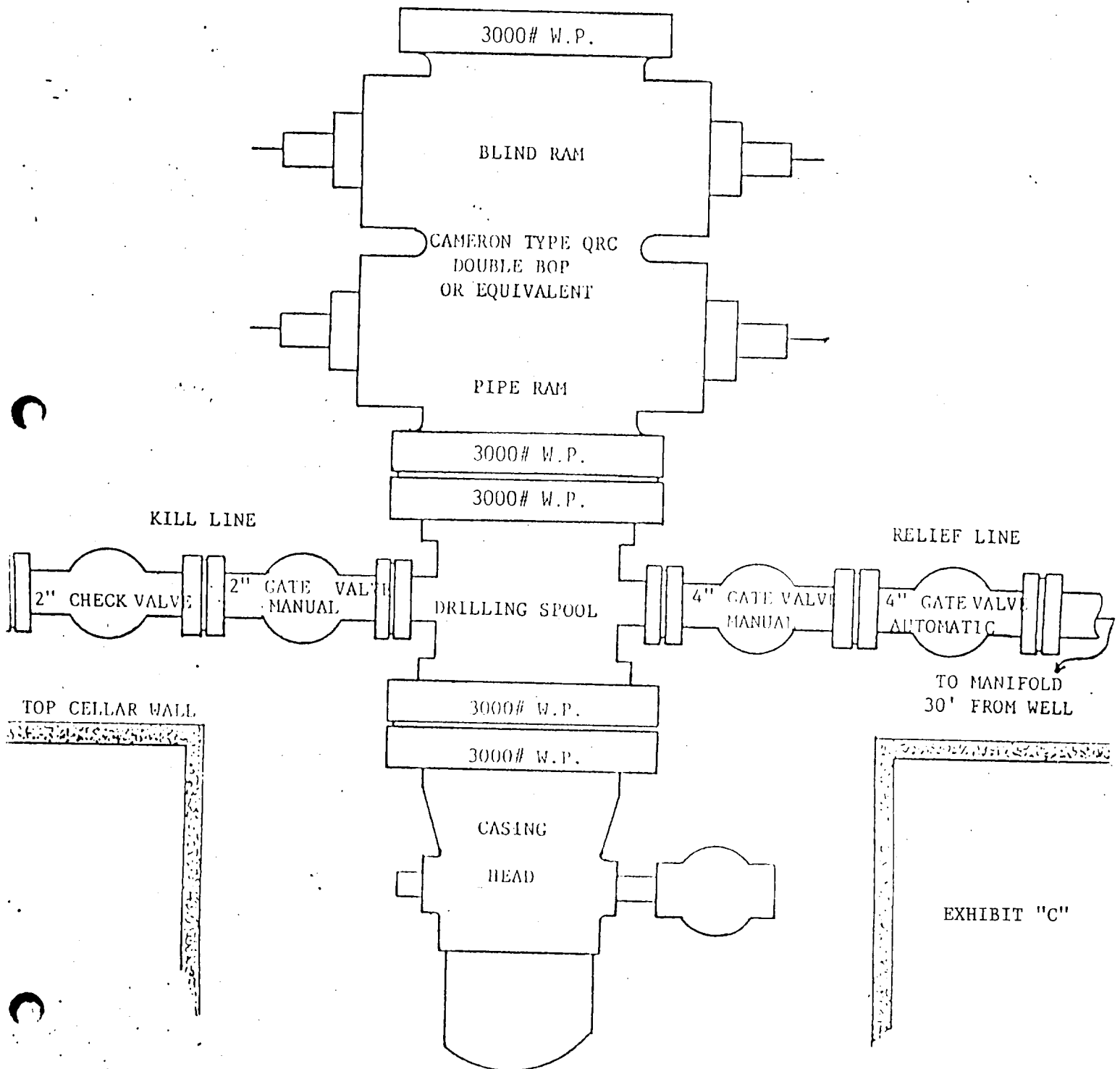

DRILLING CONTRACTOR FURNISHES EVERYTHING ABOVE CELLAR WALL