

NEW MEXICO OIL CONSERVATION COMMISSION
WELL LOCATION AND ACREAGE DEDICATION - LAT

Form C-102
Supersedes C-128
Effective 1-1-65

All distances must be from the outer boundaries of the Section.

Operator LAYTON ENTERPRISES, INC.			Lease EL ZORO FEDERAL		Well No. 2
Unit Letter H	Section 25	Township 8 SOUTH	Range 36 EAST	County ROOSEVELT	
Actual Footage Location of Well: 1830 feet from the NORTH line and 510 feet from the EAST line					
Ground Level Elev. 4048.10	Producing Formation Bough "C"		Pool Allison -Pennsylvanian		Dedicated Acreage: 80 Acres

1. Outline the acreage dedicated to the subject well by colored pencil or hachure marks on the plat below.
2. If more than one lease is dedicated to the well, outline each and identify the ownership thereof (both as to working interest and royalty). SINGLE LEASE
3. If more than one lease of different ownership is dedicated to the well, have the interests of all owners been consolidated by communitization, unitization, force-pooling, etc?

☐ Yes ☐ No If answer is "yes," type of consolidation _____

If answer is "no," list the owners and tract descriptions which have actually been consolidated. (Use reverse side of this form if necessary.) _____

No allowable will be assigned to the well until all interests have been consolidated (by communitization, unitization, forced-pooling, or otherwise) or until a non-standard unit, eliminating such interests, has been approved by the Commission.

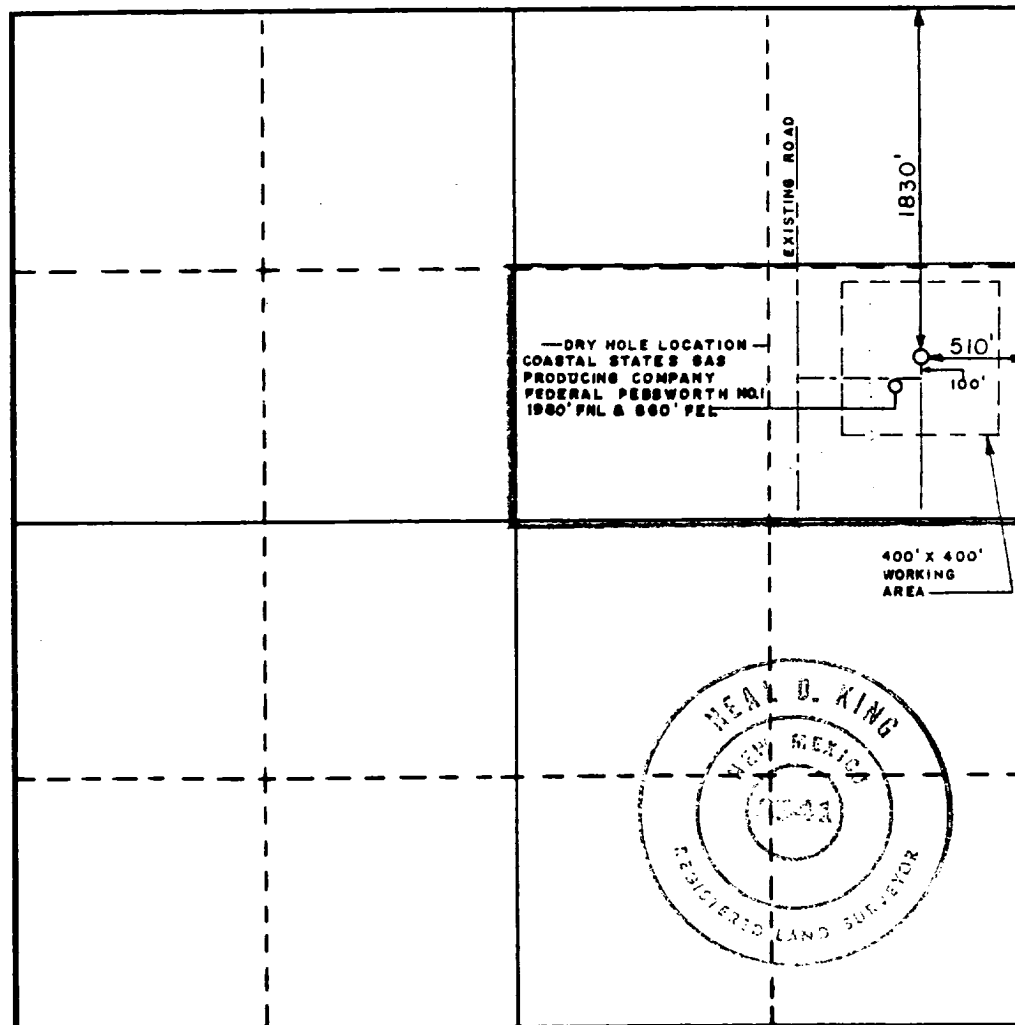

CERTIFICATION

I hereby certify that the information contained herein is true and complete to the best of my knowledge and belief.

Name
DONALD R. LAYTON

Position
President

Company
LAYTON ENTERPRISES, INC.

Date
October 18, 1985

I hereby certify that the well location shown on this plat was plotted from field notes of actual surveys made by me or under my supervision, and that the same is true and correct to the best of my knowledge and belief.

Date Surveyed
AUGUST 23, 1985

Registered Professional Engineer and/or Land Surveyor

Neal D. King

Certificate No.
R. L. S. 6541

0 200 400 600 800 1000 1200 1400 1600 1800 2000 2200 2400 2600 2800 3000 3200 3400 3600 3800 4000